

# Modulating Water Valves and Bulb Wells

**APPLICATION:** These modulating valves regulate the flow of water to the heat exchanger to maintain a desired exiting oil temperature. They open automatically when temperature increases at the sensing bulb. **No** external power source is required to actuate the valve. **Not to be** used for salt water service.

**ADJUSTMENT:** ½" to 1¼" valves can be adjusted with a screwdriver, 1½" and 2½" have a ½" square shaft. Turn the adjusting screw clockwise to **decrease** opening temperature; and counterclockwise to **increase** opening temperature. Valves are not calibrated, so final desired temperature setting must be established experimentally. Valve is fully open 36°F above opening point.

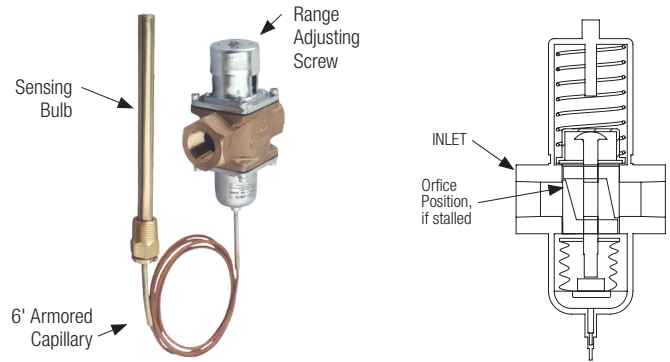

Part Number	Water Valves				Bulb Well Recommended Size
	Pipe Size (NPT)	Range (Opening Point)	Sensing Bulb Size Diameter X Length	Maximum Water Flow	
59681	½"	100°F to 175°F	5/8" x 6"	25 GPM	52941
59684	¾"	100°F to 175°F	5/8" x 8¼"	40 GPM	52942
59688	1"	100°F to 175°F	5/8" x 8¼"	55 GPM	52942
59690	1¼"	100°F to 175°F	5/8" x 8¼"	75 GPM	52942
59683	½"	60°F to 140°F	5/8" x 6"	25 GPM	52941
59686	¾"	60°F to 140°F	5/8" x 8¼"	40 GPM	52942
59687	1"	60°F to 140°F	5/8" x 8¼"	55 GPM	52942
59689	1¼"	60°F to 140°F	5/8" x 8¼"	75 GPM	52942
59691	1½"	60°F to 140°F	9/16" x 8"	90 GPM	52943
59692	2½" ASME	60°F to 140°F	3/4" x 11"	250 GPM	52944

Working pressure to 150 PSI Maximum. \*For additional protection of the bulb well stem, use the next longer bulb well.

## Water Valves

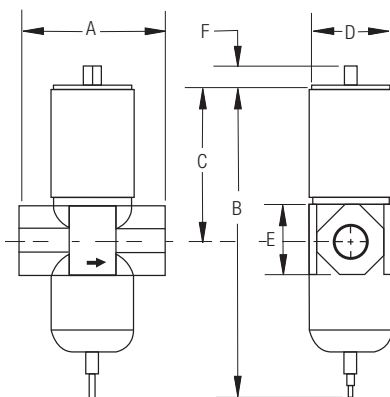

Valve Size	Dimensions (Inches)				Approximate Shipping Weight (LBS)
	A	B	C	D	
1/2"	3¼	6⅜	3⅜	2⅞	4.4
3/4"	3⅜	7⅝	3¼	2⅞	7.7
1"	4¾	8⅞	3¾	2¾	9.72
1-1/4"	5¼	8⅞	3¾	2¾	12.5
1-1/2"	5⅝	13⅝	6⅝	2¾	14
2½"	6¾	16⅞	6⅝	7	30

Valve Size	Flange Specifications (Inches)			
	Number of Bolt Holes	Bolt Hole size	Bolt Circle	Flange Diameter
2½"	4	¾	5½	7

Standard temperature elements are furnished with 6' capillary. Longer capillary lengths not available. Valve Disc: Buna N in brass disc retainer.

# Modulating Water Valves and Bulb Wells

52941

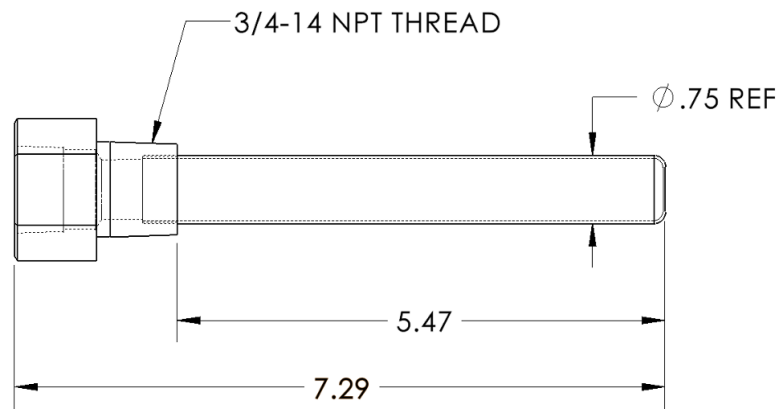

52942

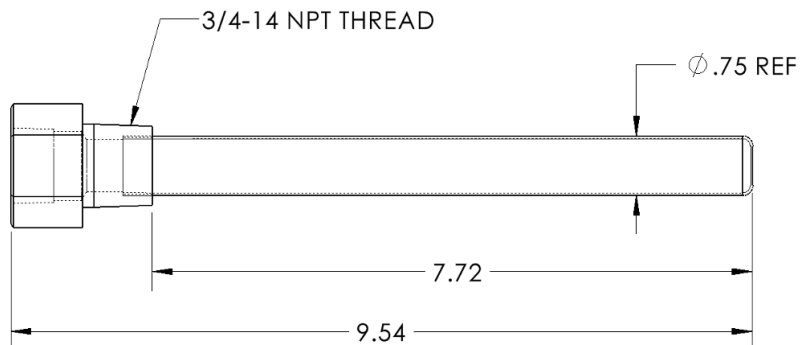

52943

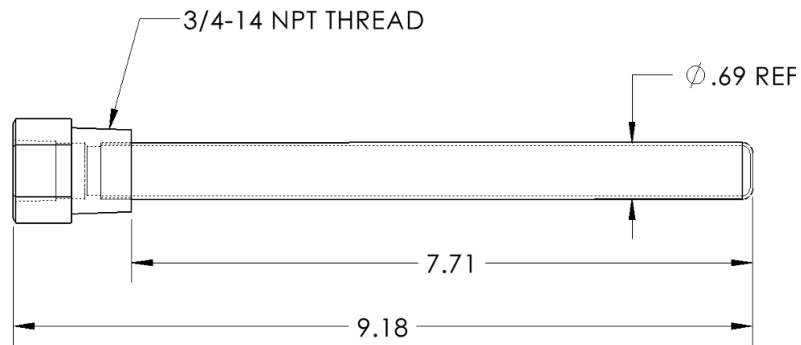

52944

